

# LED Line Light

LBEA-LSRS(100xn)W [High intensity(高輝度) model] (n=1,2,3...,20)  
 LBEA-LSRS(100xn)W-S [High uniformity(高均一) model]

\* Only 24V USE

\* Electric Power Consumption (8xn)W

(Note) Please do not remove the tags attached to the product.  
 Light-emitting part during lighting, please do not look directly.

(注) 製品に取り付けられているタグは外さないでください  
 点灯中の発光部は、直視しないでください

## Standard accessories

Dedicated slide nut : (n-1) pcs.  
 (Max. 10, Min. 2 pcs.)

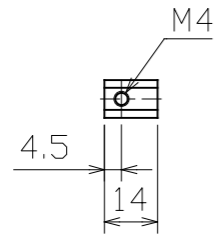

(option : M3,M5)

## Details

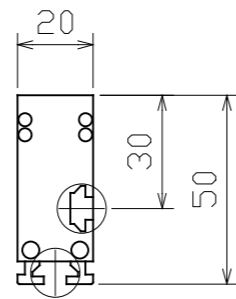
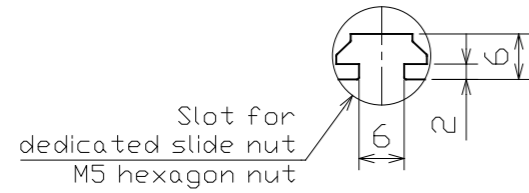

n=1~8

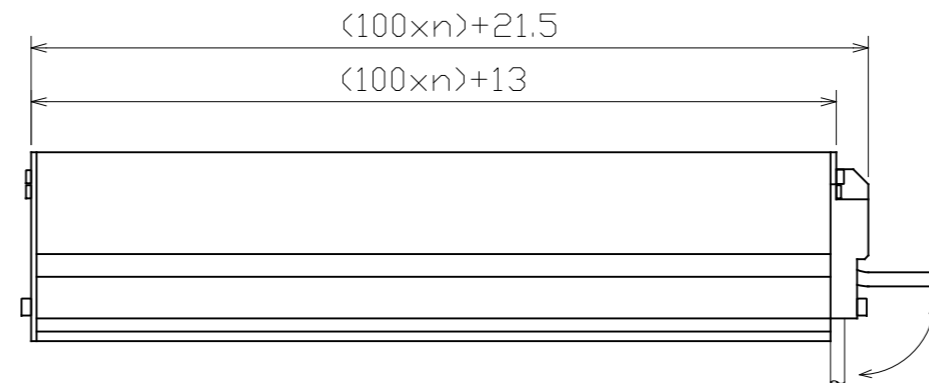
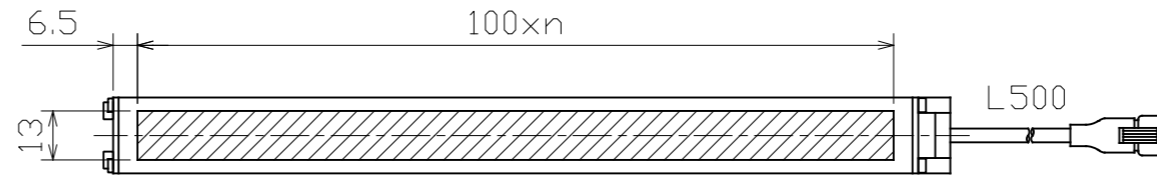

## Details of Connector

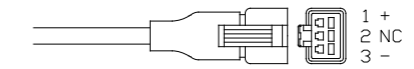

	Light	Power Supply
Connector	SMR-03V-B	SMP-03V-BC
Contact	BYM-001T-P0.6	BHF-001T-0.8SS

n=9~

